

Your Logo

Roofing Inc.
123 Main St
Houston, Texas 77095

Property Address:
123 Sample St
City, State 12345

This Report is Made by:
RoofEZ.com
Accurate Measurements, EZ Savings!
We take measuring to the next level

Roof Summary Page

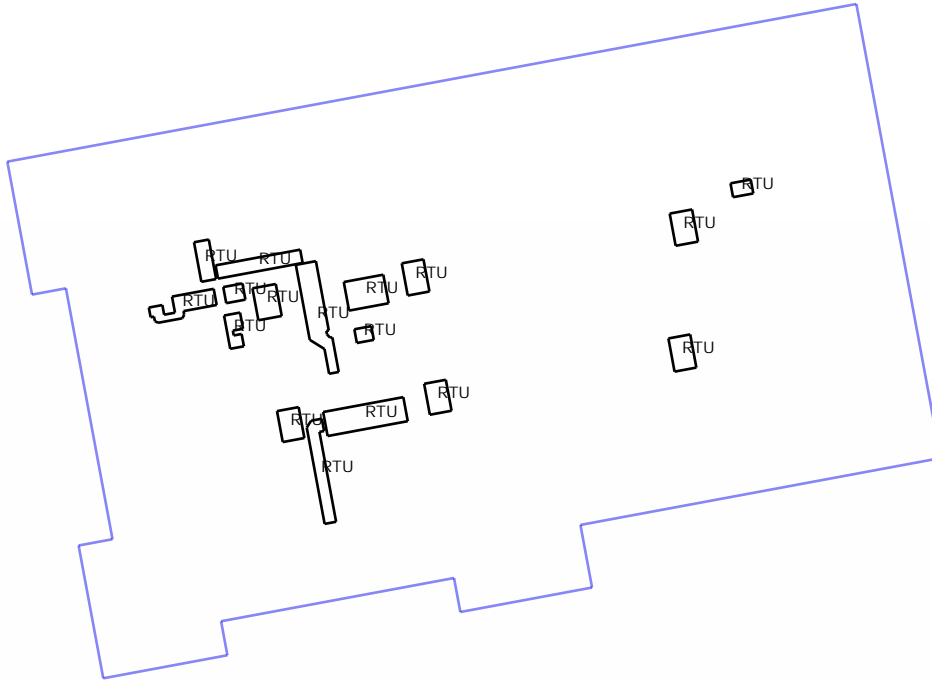

Roof Summary Info

Total Squares: 241SQ
Total Area: 24068sqft
Total Planes: 26

Total RTUs: 17
Ridge Count: 0
Ridge Length:
Eave Count: 14
Eave Length: 704'
Rake Count: 0
Rake Length:
Hip Count: 0
Hip Length:
Valley Count: 0
Valley Length:

Report Contents

| | |
|-------------------|--------|
| Length Diagram | page 2 |
| Pitch Diagram | page 3 |
| Area Diagram | page 4 |
| Notes Diagram | page 5 |
| Images | page 6 |
| Waste Calculation | page 7 |



Roofing Inc.
123 Main St
Houston, Texas 77095

Property Address:
123 Sample St
City, State 12345

This Report is Made by:
RoofEZ.com
Accurate Measurements, EZ Savings!
We take measuring to the next level

Pitch Diagram

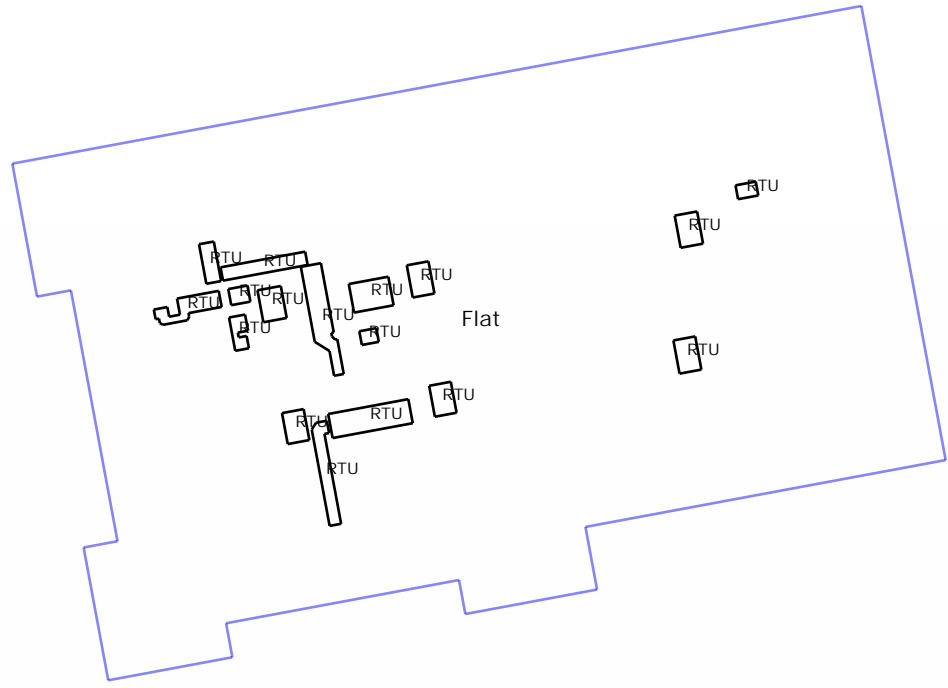

Your Logo

Roofing Inc.
123 Main St
Houston, Texas 77095

Property Address:
123 Sample St
City, State 12345

This Report is Made by:
RoofEZ.com
Accurate Measurements, EZ Savings!
We take measuring to the next level

Area Diagram

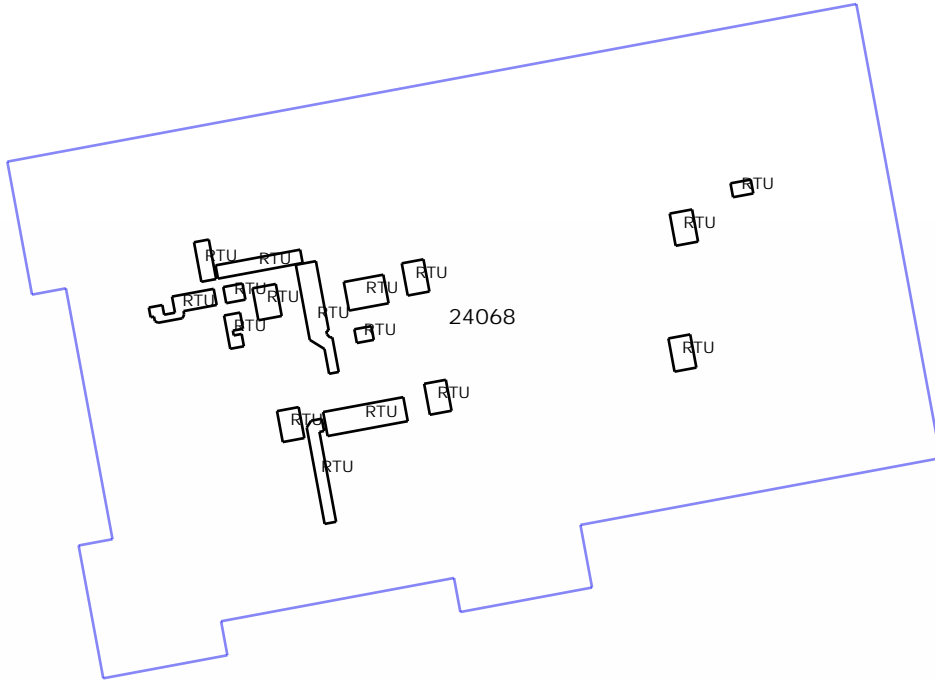

Total Squares: 241SQ
Total Area: 24068sqft
Total Planes: 26



Roofing Inc.
123 Main St
Houston, Texas 77095

Property Address:
123 Sample St
City, State 12345

This Report is Made by:
RoofEZ.com
Accurate Measurements, EZ Savings!
We take measuring to the next level

Notes Diagram

A : 24068 sqft. (3 planes)
RTU(s) : 23 planes.

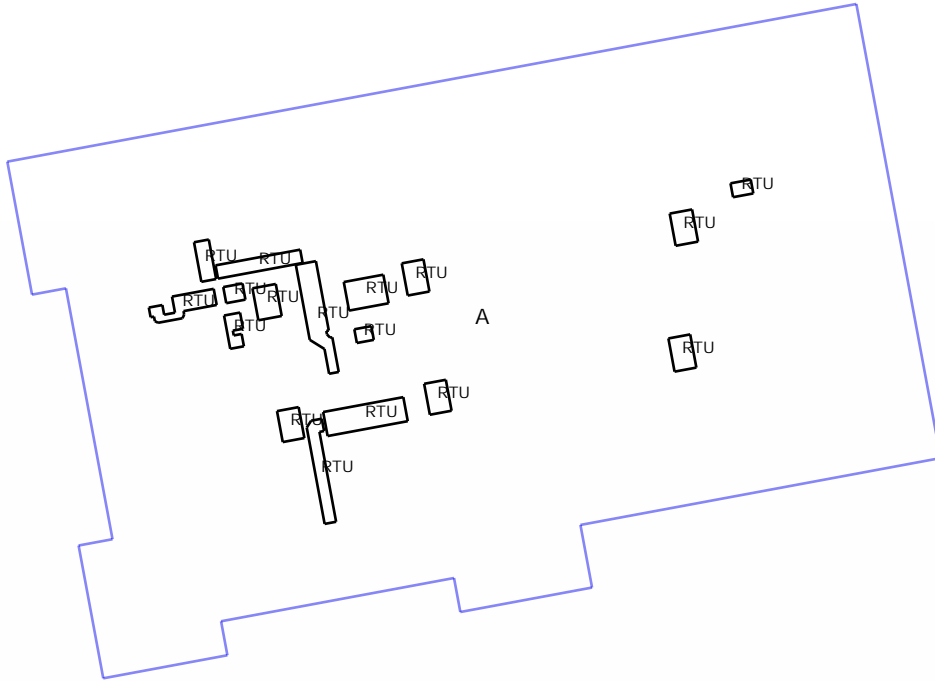

Your Logo

Roofing Inc.
123 Main St
Houston, Texas 77095

Property Address:
123 Sample St
City, State 12345

This Report is Made by:
RoofEZ.com
Accurate Measurements, EZ Savings!
We take measuring to the next level

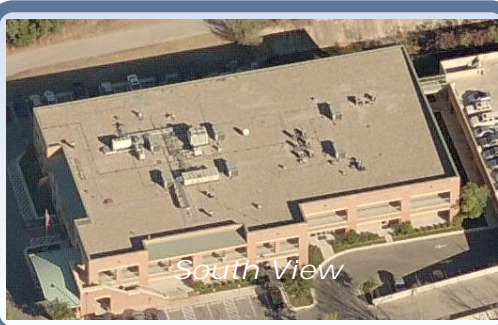



Roofing Inc.
 123 Main St
 Houston, Texas 77095

Property Address:
 123 Sample St
 City, State 12345

This Report is Made by:
RoofEZ.com
 Accurate Measurements, EZ Savings!
 We take measuring to the next level

Waste calculation

| Waste % | 0% | 5% | 10% | 15% | 20% | 25% |
|-------------|---------|---------|---------|---------|---------|---------|
| Area (sqft) | 24,068 | 25,272 | 26,475 | 27,678 | 28,882 | 30,085 |
| Squares: | 240.7SQ | 252.7SQ | 264.8SQ | 276.8SQ | 288.8SQ | 300.9SQ |